

# PWSOLAR

## 600W 120 cells series

### MONOCRYSTALLINE MODULE

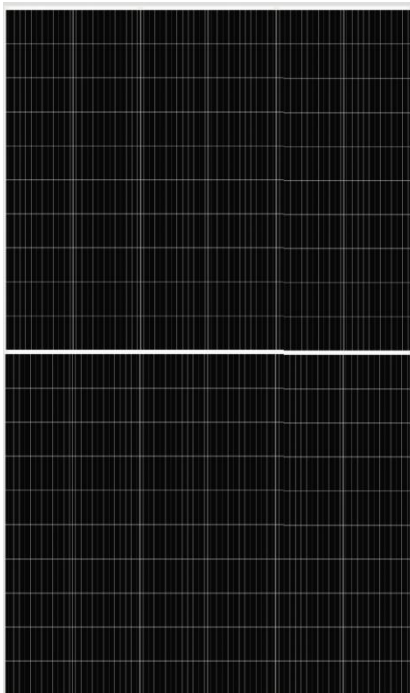

#### ADVANCED PERFORMANCE & PROVEN ADVANTAGES

- ◆ High module conversion efficiency up to 21.38% by using innovative Half-cell design and Multi-busbar(MBB) cell technology.
- ◆ Low temperature coefficient and excellent performance under high temperature and low light conditions.
- ◆ Robust aluminum frame ensures the modules to withstand wind loads up to 2400Pa and snow loads up to 5400Pa.
- ◆ High reliability against extreme environmental conditions (passing salt mist, ammonia and hail tests).
- ◆ Potential induced degradation (PID) resistance.
- ◆ Power tolerance of  $\pm 5\%$ .

#### ELECTRICAL CHARACTERISTICS AT STC

Model	PW600Wp-120M
Maximum Power ( $P_{max}$ )	600W
Power Tolerance	$\pm 5\%$
Open Circuit Voltage (VOC)	41.60V
Short Circuit Current (ISC)	18.45A
Voltage at Nominal Power ( $V_{mp}$ )	34.70V
Current at Nominal Power ( $I_{mp}$ )	17.30A
Size of Module	2172 x 1303 x 35mm
Standard Test condition	Irradiance:1000W/M2 Temp: 25°C , & AM :1.5G spectrum
Maximum system voltage	1000VDC/1500VDC
Operating temperature	- 40°C to +85°C
Module Efficiency	21.38%

#### ELECTRICAL CHARACTERISTICS AT STC

NOCT	45 $\pm$ 2°C
Voltage temperature coefficient( $V_{oc}$ )	-0.330%/°C
Current temperature coefficient ( $I_{sc}$ )	+0.058%/°C
Power temperature coefficient( $P_{mpp}$ )	-0.400%/°C
Minimum power tolerance	+/-10%
NOCT	45 $\pm$ 2°C



Room 101, No. 5 Building, No. 9 Haikou Road, Shinan District, Qingdao, China 266000

0086 532 85872070 0086 155 6392 6558 WhatsApp 0086 138 6421 6496

sales@pwsolarpower.com info@pwsolarpower.com www.pwsolarpower.com

# MECHANICAL CHARACTERISTICS

Cell Type	Monocrystalline
Number of cell	120pcs (2 x 60)
Size of Module	2172 x 1303 x 35mm
Weight	About 31.00kgs
Front Cover	3.2mm tempered glass with AR coating
Frame	Anodized aluminum alloy
Junction Box	IP68, 3 diodes
Cable	4mm <sup>2</sup> (0.006inches <sup>2</sup> ), Portrait : 300mm, Landscape: 1400mm
Connector	MC4 or MC4 compatible
Maximum Load Capacity(Pa)	2400(wind load)/2400(snow load)

# MODULE WARRANTY

12 year limited product; limited linear power warranty: 12 year 91.20% of nominal power output, 30 year 80.60% of nominal power output.  
 20 years product warranty; 30 years linear power output

- Linear performance warranty from PWSOLAR
- Standard performance warranty

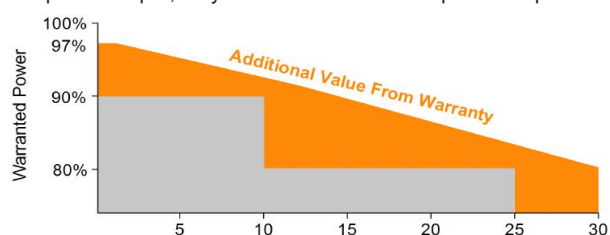

# PACKING

Standarding Packing: 27pcs/Pallet

Module Quantity of 20' container: 155pcs

Module Quantity of 40' container: 527pcs

# ENGINEERING DRAWING

Unit: mm

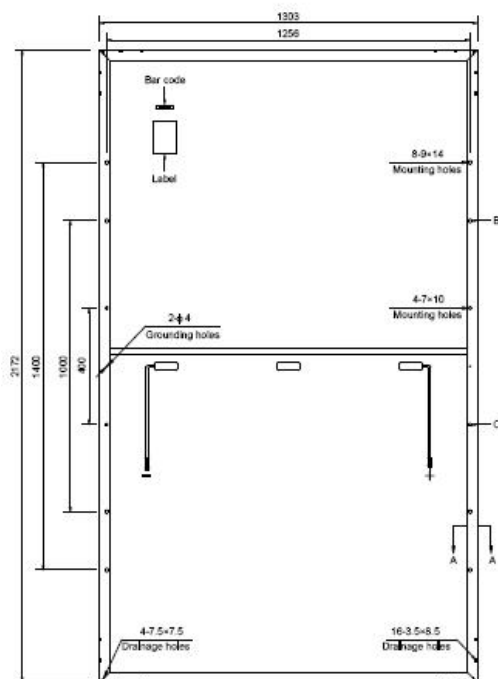

Rear View

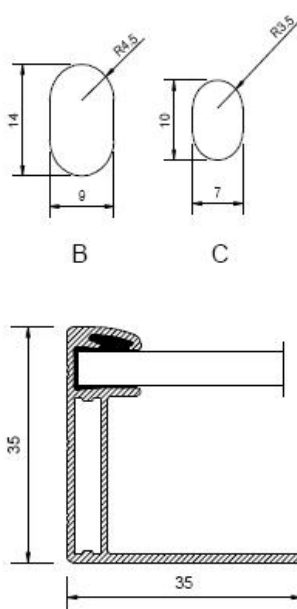

Section A-A

# IV CURVES

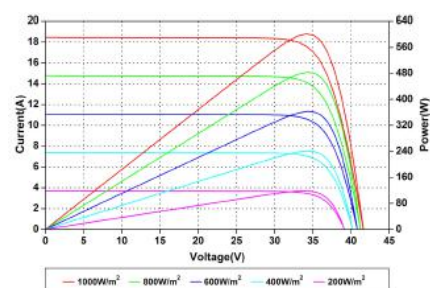

Current-Voltage and Power-Voltage Curves at Different Irradiances

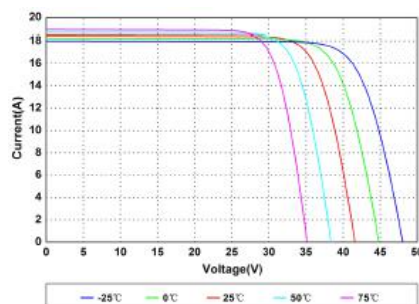

Current-Voltage Curves at Different Temperatures



Room 101, No. 5 Building, No. 9 Haikou Road, Shinan District, Qingdao, China 266000

0086 532 85872070

0086 155 6392 6558

WhatsApp 0086 138 6421 6496

sales@pwsolarpower.com

info@pwsolarpower.com

www.pwsolarpower.com

Specifications in this datasheet are subject to change without prior notice